



US006353388B1

(12) **United States Patent**
Durban et al.

(10) **Patent No.:** **US 6,353,388 B1**
(45) **Date of Patent:** ***Mar. 5, 2002**

- (54) **ANTI-THEFT VEHICLE SYSTEM**
- (75) Inventors: **Jack Durban**, Mission Viejo; **Jeffrey J. Lace**, Huntington Beach, both of CA (US)
- (73) Assignee: **Gatekeeper Systems, LLC.**, Irvine, CA (US)
- (*) Notice: Subject to any disclaimer, the term of this patent is extended or adjusted under 35 U.S.C. 154(b) by 0 days.

3,652,103 A	3/1972	Higgs
3,717,225 A	2/1973	Rashbaum et al.
3,809,191 A	5/1974	Woodward
3,820,623 A	6/1974	Akashi et al.
4,242,668 A	12/1980	Herzog
4,338,594 A	7/1982	Holm
4,424,511 A	1/1984	Alberts, Jr.
4,472,706 A	9/1984	Hodge et al.
4,577,880 A	3/1986	Bianco
4,591,175 A	5/1986	Upton et al.
4,609,075 A	9/1986	Snedeker
4,683,461 A	7/1987	Torre
4,772,880 A	9/1988	Goldstein et al.
4,809,824 A	3/1989	Fargier et al.

This patent is subject to a terminal disclaimer.

(List continued on next page.)

- (21) Appl. No.: **09/488,060**
- (22) Filed: **Jan. 19, 2000**

FOREIGN PATENT DOCUMENTS

DE	37 00411	7/1987
EP	532472	3/1993
GB	2 137 388	10/1984
GB	2 266 643	11/1993
WO	15476	9/1992

Related U.S. Application Data

- (63) Continuation of application No. 09/139,180, filed on Aug. 24, 1998, now Pat. No. 6,127,927, which is a continuation of application No. 08/637,241, filed on Apr. 24, 1996, now Pat. No. 5,831,530, which is a continuation-in-part of application No. 08/366,886, filed on Dec. 30, 1994, now Pat. No. 5,598,144.

Primary Examiner—Thomas Mullen
(74) *Attorney, Agent, or Firm*—Bliss McGlynn & Nolan, P.C.

- (51) **Int. Cl.⁷** **G08B 13/14**
- (52) **U.S. Cl.** **340/568.5; 188/111; 280/33.994**
- (58) **Field of Search** **340/568.5, 426, 340/825.69, 825.72; 188/111; 280/33.994**

(57) **ABSTRACT**

An anti-theft vehicle system for a vehicle wheel having a rotational axis includes at least one inhibitor disposed within the vehicle wheel to selectively engage and disengage the vehicle wheel to resist and allow rotational movement of the vehicle wheel about its rotational axis. The anti-theft vehicle system also includes rotatable structure disposed within the vehicle wheel and cooperating with the at least one inhibitor for moving the at least one inhibitor between an engaged position and a disengaged position with respect to the vehicle wheel. The anti-theft vehicle system further includes a receiver operatively associated with the vehicle wheel to receive a predetermined signal to activate the rotatable structure to move the at least one inhibitor between the engaged position and disengaged position.

(56) **References Cited**
U.S. PATENT DOCUMENTS

1,928,750 A	10/1933	Apple et al.
1,968,584 A	7/1934	Apple
2,964,140 A	12/1960	Berezny
3,029,905 A	4/1962	Nowak
3,031,037 A	4/1962	Stollman
3,031,038 A	4/1962	Chait
3,117,655 A	1/1964	Skupas et al.
3,157,871 A	11/1964	Umanoff
3,495,688 A	2/1970	Isaacks
3,590,962 A	7/1971	Parker et al.

18 Claims, 5 Drawing Sheets

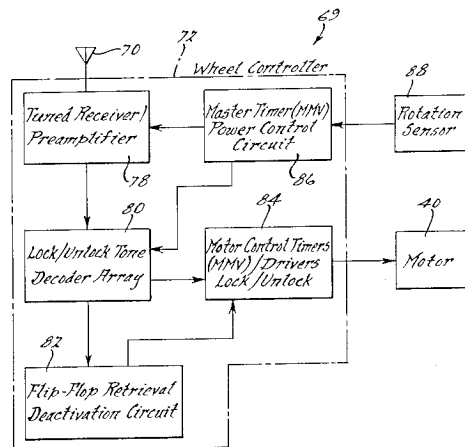

U.S. PATENT DOCUMENTS

4,868,544 A	9/1989	Havens	5,349,329 A	9/1994	Smith
4,878,050 A	10/1989	Kelley	5,357,182 A	10/1994	Wolfe et al.
4,908,604 A	3/1990	Jacob	5,394,962 A	3/1995	Gray
4,987,406 A	1/1991	Reid	5,432,412 A	7/1995	Harris et al.
4,990,890 A	2/1991	Newby	5,465,986 A	11/1995	MacRae
5,000,297 A	3/1991	Shaw et al.	5,576,691 A	11/1996	Coakley et al.
5,053,768 A	10/1991	Dix, Jr.	5,598,144 A	1/1997	Lace
5,194,844 A	3/1993	Zelda	5,607,030 A	3/1997	Swift et al.
5,283,550 A	2/1994	MacIntyre	5,821,856 A	10/1998	Lace
5,315,290 A	5/1994	Moreno et al.	5,831,530 A	11/1998	Lace et al.

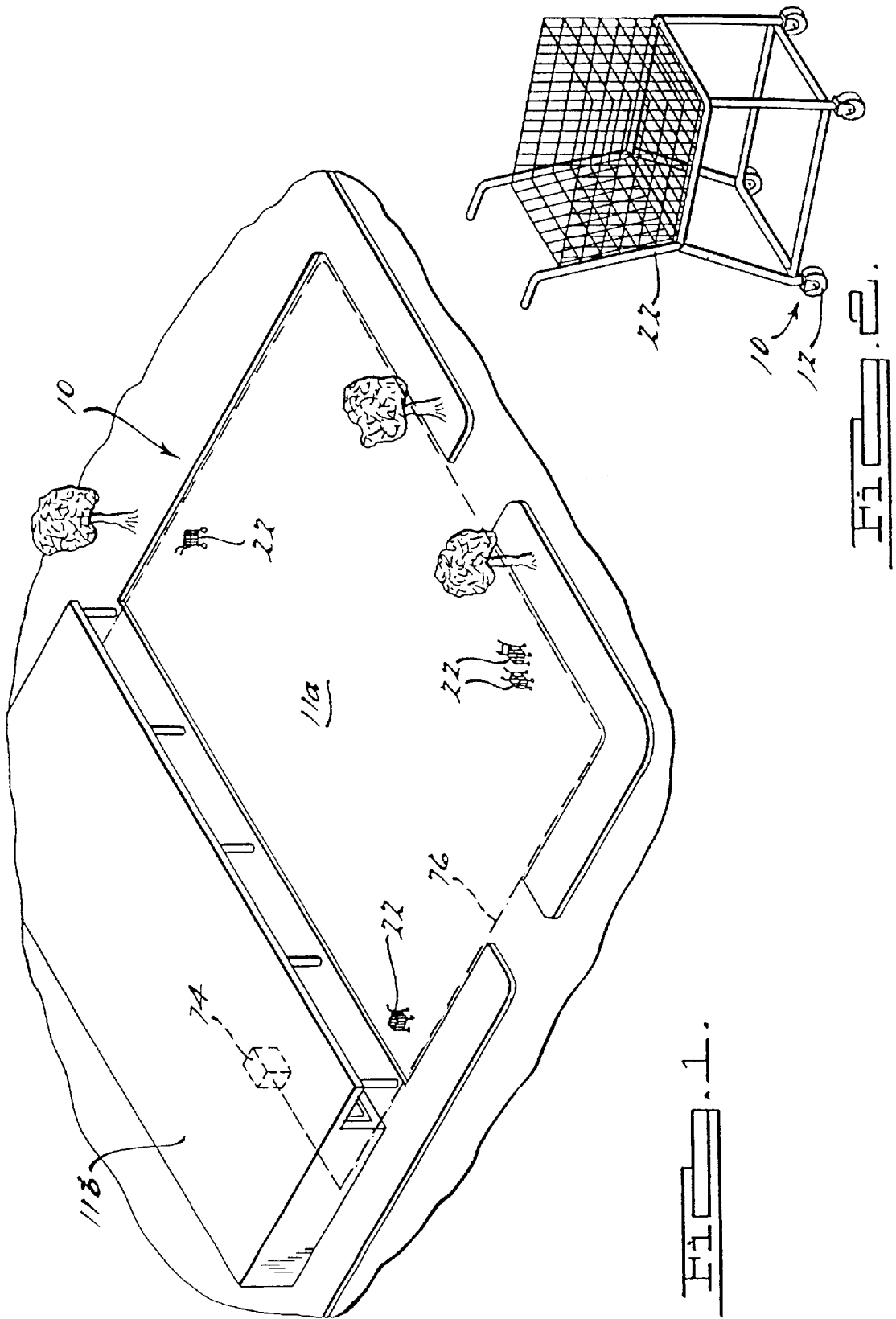
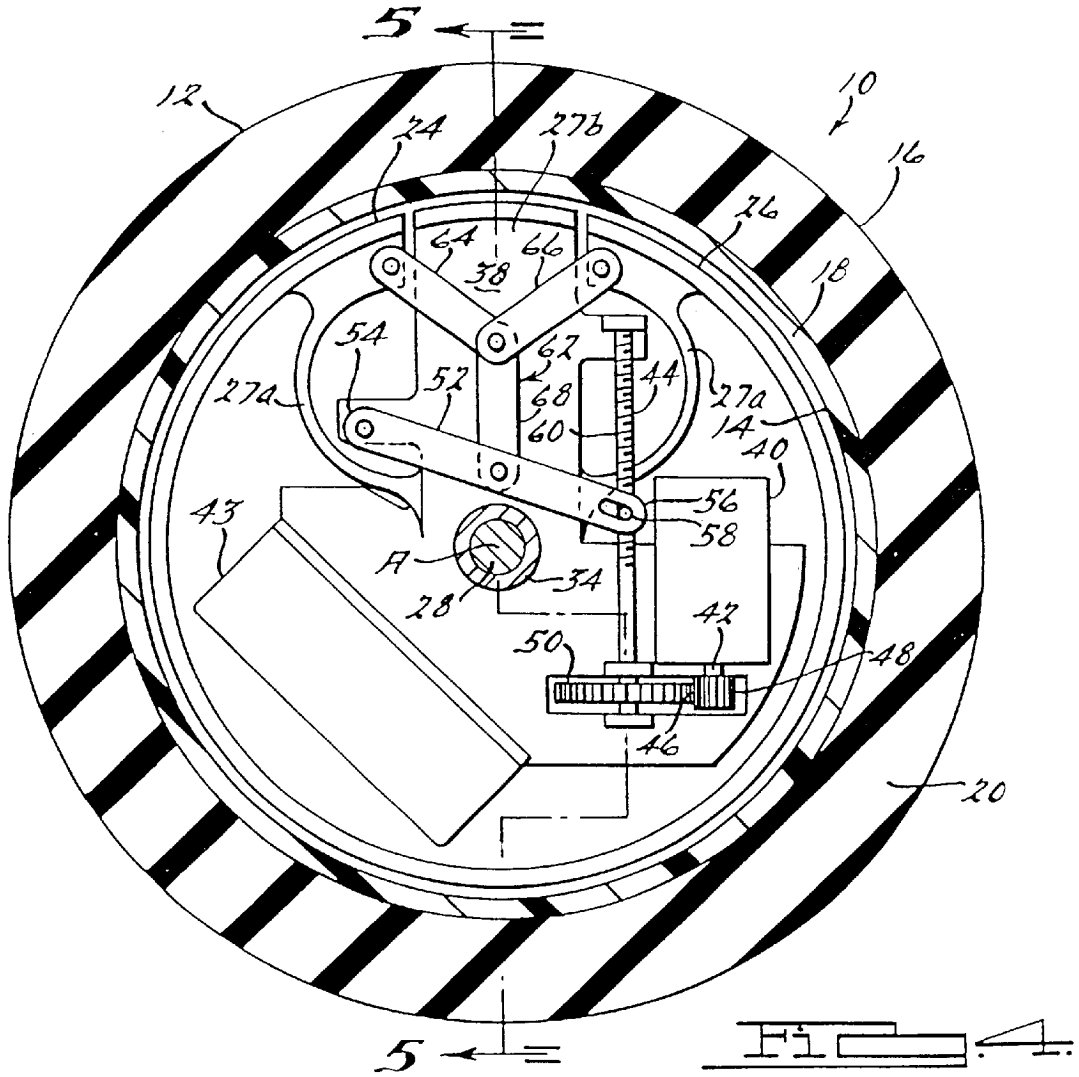
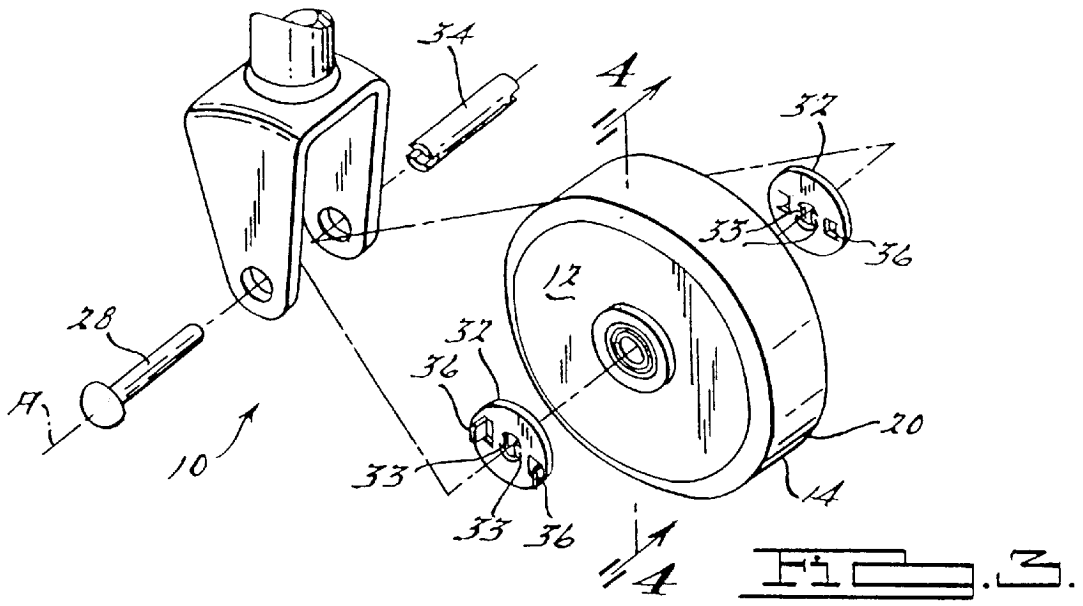

FIG. 1.

FIG. 2.



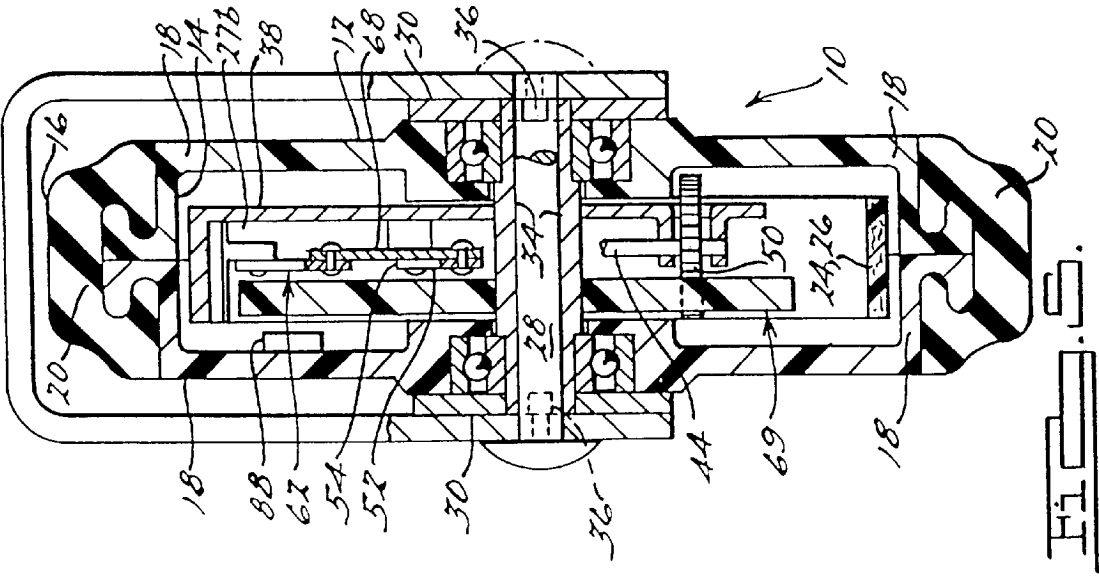
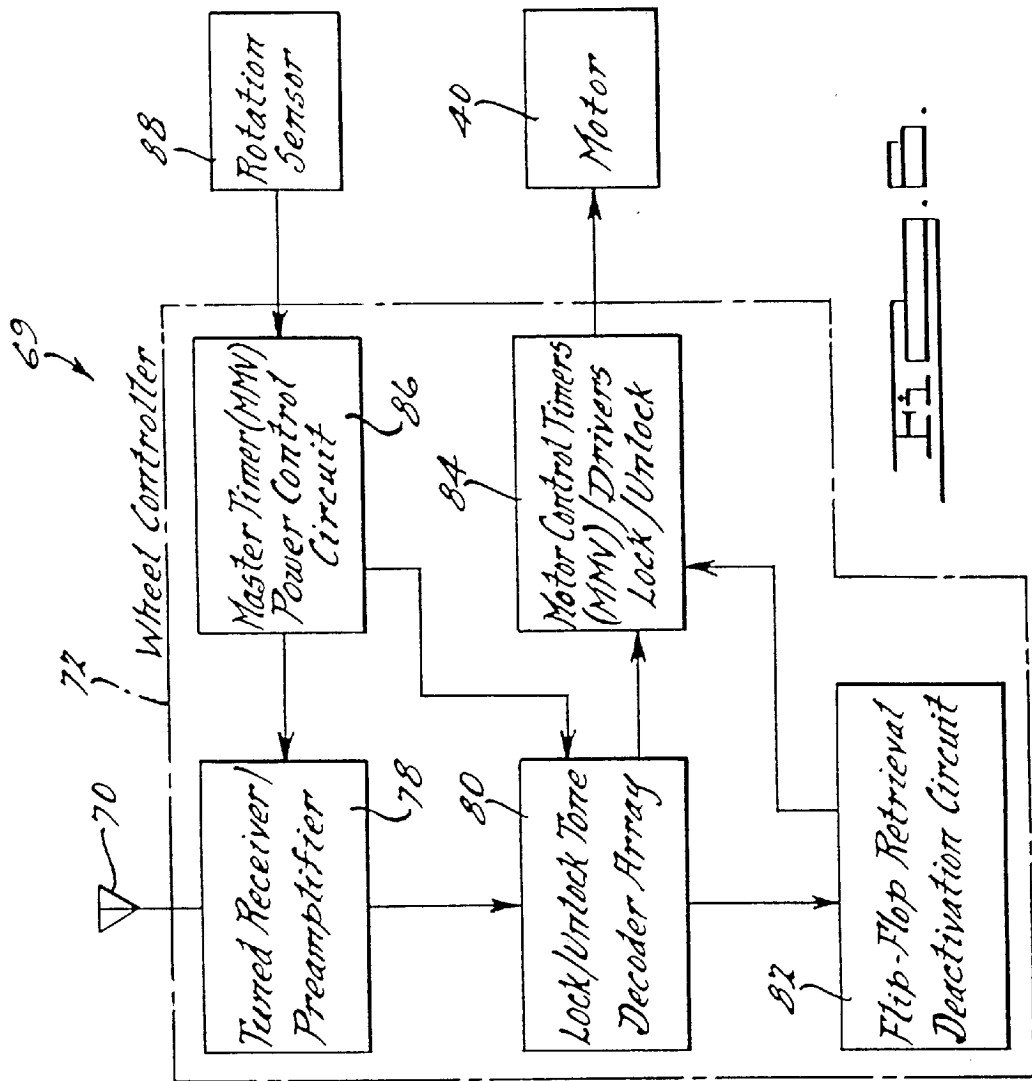
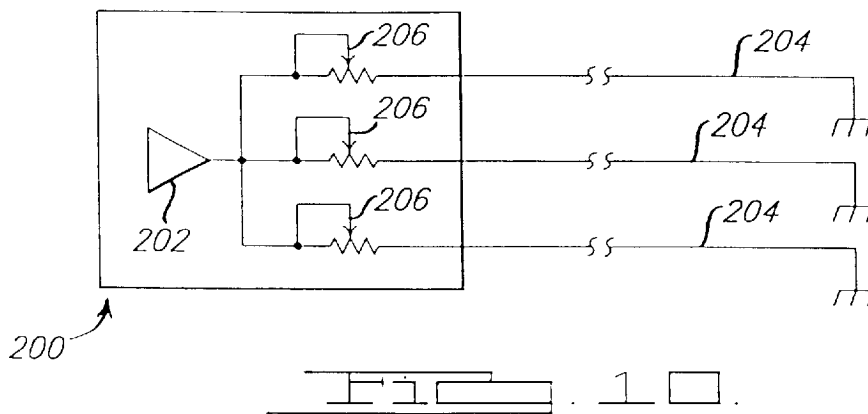
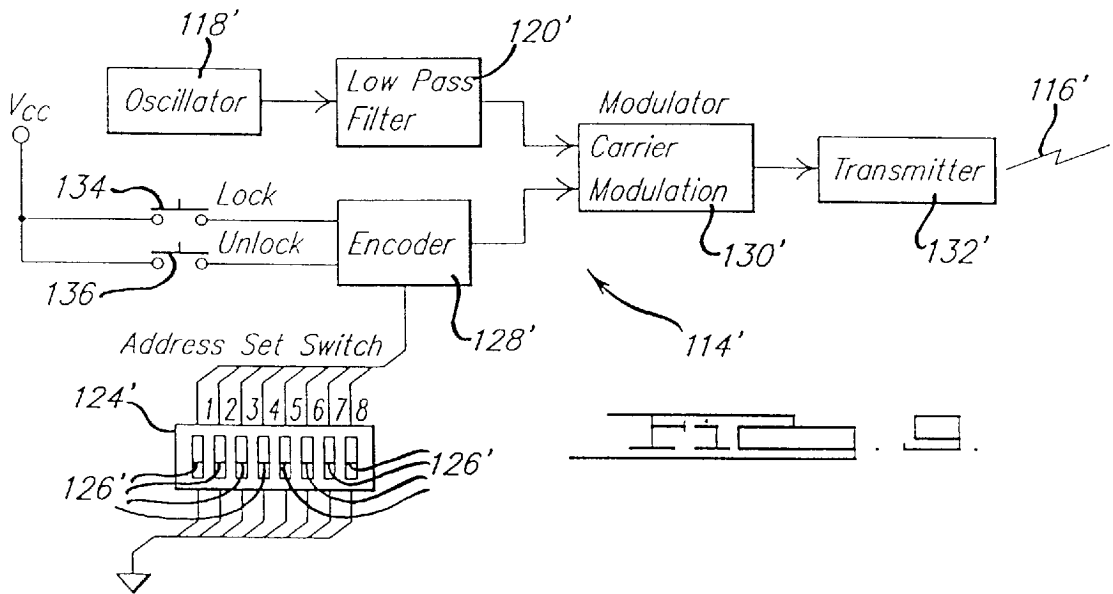
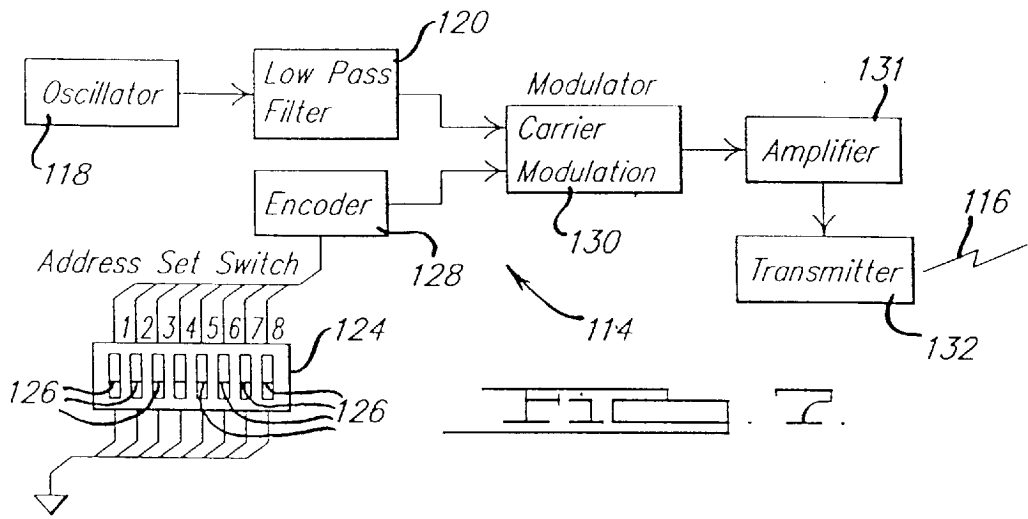
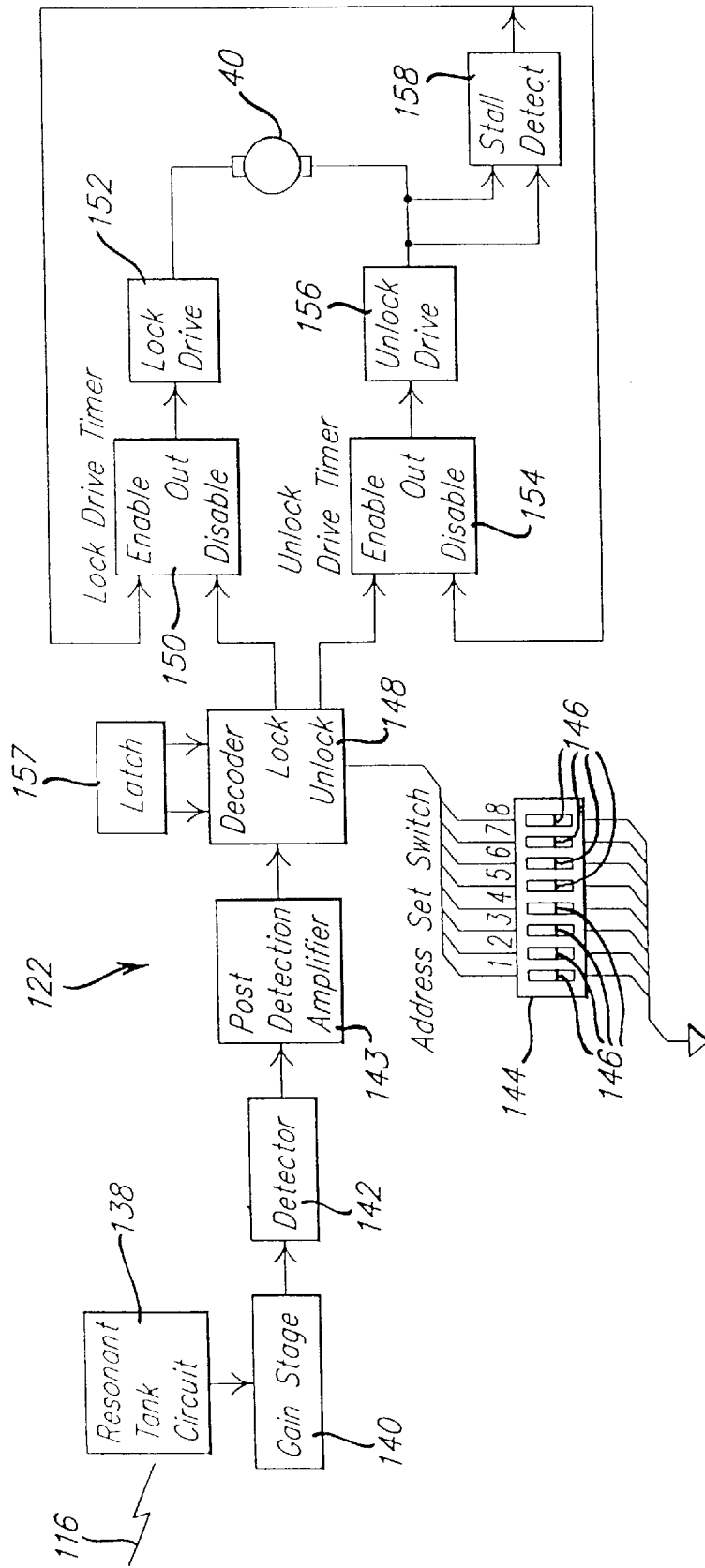

FIG. 5.





ANTI-THEFT VEHICLE SYSTEM

CROSS-REFERENCE TO RELATED APPLICATION(S)

This application is a continuation of U.S. Ser. No. 09/139, 180, filed Aug. 24, 1998, now U.S. Pat. No. 6,127,927, which is a continuation of U.S. Ser. No. 08/637,241, filed Apr. 24, 1996, now U.S. Pat. No. 5,831,530, which is a Continuation-In-Part of application U.S. Ser. No. 08/366, 886, filed Dec. 30, 1994, now U.S. Pat. No. 5,598,144.

BACKGROUND OF THE INVENTION

1. Field of the Invention

The present invention relates generally to vehicles and, more particularly, to an are bounded vehicle system used to inhibit rotation of a vehicle wheel outside a predetermined spatial perimeter to mitigate the theft of vehicles or limit the travel thereof to within a specific boundary.

2. Description of the Related Art

It is sometimes desired to contain a vehicle within a predetermined spatial boundary or perimeter. In particular, retail stores are attempting to reduce the amount of lost vehicles such as shopping carts, which are either stolen or taken out of the normal bounds of the stores and not returned.

Accordingly, U.S. Pat. No. 5,194,844 to Zelda discloses a vehicle theft prevention system which inhibits the use of a shopping cart once it is moved outside a boundary. This patented system includes an electronic wire that extends around and defines a perimeter of normal operating space which is used by operators of a store's shopping carts. The electronic wire produces an electromagnetic field which is sensed by a sensor located adjacent one wheel of the shopping cart. The sensor sends a signal to a motor which moves a brake pad against the wheel of the shopping cart. Two limit switches are used to stop the motor when the motor has either moved the brake pad into or out of engagement with the wheel of the shopping cart.

One disadvantage of the above system is that it is relatively expensive because the motor must be large and two limit switches are needed. Another disadvantage of the above system is that an asymmetric time-variant wave form is used for the electromagnetic field which is undesired.

SUMMARY OF THE INVENTION

It is, therefore, one object of the present invention to provide an anti-theft vehicle system for vehicles.

It is another object of the present invention to provide an anti-theft vehicle system for vehicles such as shopping carts, toys, wheeled inventory, and industrial forklifts.

It is yet another object of the present invention to provide an anti-theft vehicle system for a vehicle wheel to prevent an operator from moving the vehicle outside a predetermined spatial perimeter.

It is still another object of the present invention to provide an anti-theft vehicle system for a shopping cart wheel which is inexpensive and effective at making it difficult for an operator to move the shopping cart out of a predetermined operating area of a retail store.

To achieve the foregoing objects, the present invention is an anti-theft vehicle system for a vehicle wheel having a rotational axis. The anti-theft vehicle system includes at least one inhibitor disposed within the vehicle wheel to selectively engage and disengage the vehicle wheel to resist

and allow rotational movement of the vehicle wheel about its rotational axis. The anti-theft vehicle system also includes rotatable means disposed within the vehicle wheel and cooperating with the inhibitor for moving the inhibitor between an engaged position and a disengaged position with the vehicle wheel. The anti-theft vehicle system further includes a receiver operatively associated with the vehicle wheel to receive a predetermined signal to actuate the rotatable means to move the at least one inhibitor between the engaged position and disengaged position.

One advantage of the present invention is that an anti-theft vehicle system is provided for vehicles such as shopping carts, toys, wheeled inventory, and industrial forklifts. Another advantage of the present invention is that the anti-theft vehicle system provides a vehicle wheel which deters an operator from moving the vehicle outside a predetermined spatial perimeter. Yet another advantage of the present invention is that the anti-theft vehicle system provides a cost effective vehicle wheel to deter operators from taking shopping carts out of a retail store's shopping cart boundary by preventing the vehicle wheel from rotating. Still another advantage of the present invention is that the anti-theft vehicle system provides a one-piece brake, springs and component mounting area for the vehicle wheel. A further advantage of the present invention is that the anti-theft vehicle system is self-energizing in both directions. Yet a further advantage of the present invention is that the anti-theft vehicle system provides a linkage overrun for position lock of the vehicle wheel. Still a further advantage of the present invention is that the anti-theft vehicle system changes the angle of a thrust arm to maximize brake linkage efficiency.

Other objects, features and advantages of the present invention will be readily appreciated as the same becomes better understood after reading the subsequent description when considered in connection with the accompanying drawings.

BRIEF DESCRIPTION OF THE DRAWINGS

FIG. 1 is a perspective view of a anti-theft vehicle system, according to the present invention, illustrated in operational relationship with vehicles and a predetermined spatial perimeter.

FIG. 2 is a perspective view of a vehicle and the anti-theft vehicle system of FIG. 1.

FIG. 3 is an exploded view of a wheel of the vehicle and the anti-theft vehicle system of FIG. 2.

FIG. 4 is a sectional view taken along line 4—4 of FIG. 3.

FIG. 5 is a sectional view taken along line 5—5 of FIG. 4.

FIG. 6 is a schematic view of a control circuit of the anti-theft vehicle system of FIGS. 1 through 3.

FIG. 7 is a schematic view of a transmitting circuit, according to the present invention, of the anti-theft vehicle system of FIGS. 1 through 3.

FIG. 8 is a schematic view of another embodiment of a control circuit, according to the present invention, of the anti-theft vehicle system of FIGS. 1 through 3.

FIG. 9 is a schematic view of another embodiment, according to the present invention, of the transmitting circuit of FIG. 7.

FIG. 10 is a block view of an alternative embodiment, according to the present invention, of a multiple antenna driver.

DESCRIPTION OF THE PREFERRED EMBODIMENT(S)

Referring to FIG. 1, one embodiment of an anti-theft vehicle system 10, according to the present invention, is shown in operational relationship with vehicles inside a predetermined spatial boundary. In one embodiment, the system 10 is used to prevent theft of vehicles such as shopping carts 22 from a predetermined spatial boundary or perimeter 11a of a retail store 11b. It should be appreciated that the system 10 may be used on other vehicles such as toys, wheeled inventory, industrial forklifts to prevent the same from exiting a predetermined spatial boundary.

As illustrated in FIGS. 2 through 5, the system 10 includes at least one wheel 12 for the vehicle embodiment of a shopping cart 22. The wheel 12 has an inner diameter 14 and an outer diameter 16 and a rotational axis A about which the wheel 12 rotates. The wheel 12 also has a housing or hub 18 and a surface engaging member 20. The surface engaging member 20 is made of a suitable material such as a plastic material. Preferably, the plastic material is a urethane material. The hub 18 may be fabricated from the same material as the surface engaging member 20. Preferably, the hub 18 is made of a plastic material such as ABS and secured to the surface engaging member 20.

The system 10 also includes at least one inhibitor 24 disposed within the wheel 12 to selectively engage the wheel 12 and prevent the wheel 12 from rotating about its rotational axis A. The inhibitor 24 is a partial cylindrical shaped brake pad which is forced against the inner diameter 14 or hub 18 of the wheel 12. In one embodiment, a second inhibitor 26 is disposed within the wheel 12 to selectively engage another portion of the hub 18 of the wheel 12. The second inhibitor 26 is also a partial cylindrical shaped brake pad which is forced against the inner diameter 14 of the wheel 12. The inhibitors 24, 26 are integral and made of one-piece. The inhibitors 24, 26 are fabricated from a plastic material, such as a glass reinforced nylon material, which has a memory quality to maintain the shape of the inhibitors 24, 26. The inhibitors 24, 26 have a spring 27a connected to an extension 27b which acts as a component mounting area. The memory quality of the plastic material for the springs 27a creates a spring-like force predisposing the inhibitors 24, 26 to disengage the wheel 12. It should be appreciated that the inhibitors 24, 26, springs 27a and extension 27b are fabricated as one-piece from the same material.

The system 10 further includes an axle pin or shaft 28 which acts as the rotational axis A for the wheel 12. The shaft 28 is made of a metal material such as steel. The system 10 also includes two waterproof bearings 30 and yoke lock plates 32 supported by the shaft 28. The yoke lock plates 32 have internal notches 33 which engage an axle 34 and prevent the axle 34, which rides along the shaft 28, from rotating. The yoke lock plates 32 also include tabs 36 which prevent the waterproof bearings 30 from rotating.

The system 10 includes an axle arm 38 securely mounted such as by welding about the axle 34. The axle arm 34 is a plate made of a metal material such as steel. The extension 27b is connected to the axle arm 38 by suitable means such as an adhesive. The system 10 also includes a motor 40 such as an electric motor mounted to the extension 27b of the inhibitors 24, 26 between the rotational axis A and the inner diameter 14. The motor 40 provides rotational movement independent of the movement of the wheel 12 along an axis defined by a motor shaft 42. The motor 40 receives power from a power source such as a battery 43 which is electrically connected to both the motor 40 and a wheel controller

72 to be described. It should be appreciated that the battery 43 is attached to the extension 27b of the inhibitors 24, 26 by suitable means.

The system 10 further includes a screw or worm gear 44 rotated by the motor 40 through a gear drive 46. The gear drive 46 allows the motor 40 to be placed along side the worm gear 44, conserving space, and reduces the rotational speed of the worm gear 44. More specifically, the gear drive 46 includes a first gear 48 and a second gear 50 such that the second gear 50 has a larger diameter than the first gear 48. The first gear 48 is secured to the motor shaft 42 and rotates at a faster rate than the second gear 50 which is driven by the first gear 48. It should be appreciated that the gear drive 46 may use any number of gears and gear sizes depending on the size and motor speed requirements.

The system 10 also includes a drive arm or lever 52 connected to the axle arm 38. The lever 52 has a pivotal end 54 and a gear engaging end 56. The gear engaging end 56 receives the worm gear 44 and moves along the worm gear 44 as the worm gear 44 is rotated. The gear engaging end 56 includes a nut 58 for receiving the worm gear 44 therein and rides along the worm gear 44 as the nut 58 receives the threads 60 of the worm gear 44.

The lever 52 pivots about a pivot end 54 which is pivotally secured to the axle arm 38. When the lever 52 pivots about the pivot end 54, the inhibitors 24, 26 and the wheel 12 engage to prevent the rotational movement of the wheel 12. If, however, the inhibitors 24, 26 are already engaging the wheel 12, the motor 40 will reverse to pivot the lever 52 back toward the motor 40 to disengage the inhibitors 24, 26 from the wheel 12, allowing the wheel 12 to rotate along with the other wheels of the shopping cart 22.

The system 10 also includes a linkage, generally indicated at 62, to connect the inhibitors 24, 26 to the lever 52. The linkage 62 is connected to the lever 52 between the pivotal end 54 and the gear engaging end 56. The linkage 62 includes a first thrust arm or link 64 and a second thrust arm or link 66 which are pivotally moveable with respect to each other. The first and second links 64 and 66 are pivotally secured to each of the first and second inhibitors, 24 and 26, respectively.

The linkage 62 further includes a transfer arm or principle link 68 which is pivotally secured to the first and second links 64 and 66 and the lever 52. The movement allowed by the principle link 68 forces the first and second links 64 and 66 to move in opposite directions. When the two links 64, 66 move in opposite directions, the first and second inhibitors 24, 26 move in opposite directions, either into engagement or disengagement with the hub 18 of the wheel 12. Although not necessary, the first and second links 64 and 66 are identical in shape and move not only in opposite directions but with equal magnitude. Further, the cost of the system 10 is further reduced by having the first, second and principle links 64, 66 and 68 fabricated to the same shape and size. This reduces the cost of the system 10 further by reducing parts.

Referring to FIG. 6, the anti-theft vehicle system 10 includes a receiver or control circuit, generally shown at 69, for the system 10. The control circuit 69 is a circuit board overlay which is disposed within the hub 18 of the wheel 12. The control circuit 69 receives a predetermined perimeter signal to activate the motor 40 to move the inhibitors 24, 26 such that the inhibitors 24, 26 either engage or disengage the wheel 12. Preferably, the control circuit 69 includes an antenna 70 which receives the predetermined perimeter signal such as an RF signal created by a signal generator 74 to be described.

The control circuit 69 also includes a wheel controller 72 which receives the predetermined perimeter signal from the antenna 70 and is electrically connected between the antenna 70 and the motor 40. The wheel controller 72 selectively activates the motor 40 based on the coded predetermined perimeter signal received from the antenna 70. The predetermined perimeter signal is created by a signal generator 74 and buried wire cable 76 to be described and illustrated in FIG. 1.

The wheel controller 72 includes a tuned receiver 78 which receives the predetermined perimeter signal from the antenna 70. The wheel controller 72 also includes a tone decoder 80 which receives the predetermined perimeter signal from the tuned receiver 78. The tuned receiver 78 amplifies the predetermined perimeter signal and sends it to the tone decoder 80 for decoding. The wheel controller 72 also includes a flip flop retrieval deactivation circuit 82 and a motor controller timer 84. The flip flop retrieval deactivation circuit 82 receives the predetermined perimeter signal once it has been decoded and determines which direction the motor 40 is to rotate the motor shaft 42. The flip flop retrieval deactivation circuit 82 signals the motor controller timer 84 to operate the motor 40 dependent upon the signal received by the flip flop retrieval deactivation circuit 82 and the tone decoder 80. The wheel controller 72 includes a master timer 86 which receives input from a rotation sensor 88 such as a magnet.

For example, the shopping cart 22 passes over the buried wire cable 76 to signify that the shopping cart 22 has passed either into or out of the predetermined spatial perimeter 119 defined by the buried wire cable 76. The flip flop retrieval deactivation circuit 82 receives the predetermined perimeter signal from the tuned receiver 78 stating the location of the shopping cart 22 has changed. The flip flop retrieval deactivation circuit 82 then determines whether the shopping cart 22 was inside or outside the buried wire cable 76 by determining whether the wheel 12 was rotating. From the rotation sensor 88, determination of the rotation of the wheel 12 will determine whether the shopping cart 22 was inside or outside of the buried wire cable 76. If the rotation sensor 88 produces no signal, the wheel 12 is not rotating and is already locked. Therefore, receiving a signal from the tuned receiver 78 will indicate that the shopping cart 22 has passed back over the predetermined spatial perimeter 11a and into the allowed area for the shopping cart 22 to operate. The rotational state of the wheel 12 goes from a non-rotating state to a rotating state. If, however, the flip flop retrieval deactivation circuit 82 receives a signal from the tuned receiver 78 when the rotation sensor 88 is sending a signal indicating that the wheel 12 is rotating, it will be determined that the shopping cart 22 has moved to a location outside of the predetermined spatial perimeter defined by the buried wire cable 76. As a result, the motor 40 will be activated such that the inhibitors 24, 26 will abut the wheel hub 18 preventing the wheel 12 from rotating. Thus, the rotational state of the wheel 12 has gone from a rotating state to a non-rotating state.

The signal generator 74, shown in FIG. 1, generates a square wave output having a low frequency cycle between 60 Hz and 1 kHz which is sent along the buried wire cable 76 and defines the predetermined spatial perimeter 11a. As a result, the shopping cart 22 may operate inside the area defined by the predetermined spatial perimeter 11a. It should be appreciated that the signal generator 74 may be any type of signal generator suitable to produce a signal which will pass along the entire length of the buried wire cable 76.

Referring to FIG. 7, one embodiment of a transmitting circuit 114, according to the present invention, is shown for

the anti-theft vehicle system 10. The transmitting circuit 114 generates a predetermined perimeter signal of magnetic flux, graphically represented by line 116, defining the predetermined spatial perimeter 11a of an area such as a parking lot of a retail store 11b. The transmitting circuit 114 includes an oscillator 118 for creating a carrier signal defining a carrier frequency at a fundamental frequency less than nine kilohertz (9.0 kHz). Preferably, the carrier signal is defined by a square wave. It should be appreciated that the square wave at a carrier frequency less than nine kilohertz (9.0 kHz) may have harmonics which are greater than nine kilohertz (9.0 kHz).

The transmitting circuit 114 also includes a low pass filter 120 which receives the carrier frequency created by the oscillator 118. The low pass filter 120 eliminates all carrier harmonics other than the fundamental harmonic created by the signal defined by the carrier frequency which results in a sine wave. In another embodiment, the low pass filter 120 may be designed to allow the carrier harmonics other than the fundamental harmonic to pass therethrough and be received by a receiving circuit 122 to be described. It should be appreciated that the low pass filter 120, which allows lower carrier harmonics to pass therethrough, permits a control circuit 122 to be described to couple and decode the lower carrier frequencies at one of the harmonics of the fundamental carrier harmonic. As a result, smaller electronic componentry can be used which allows for a more inexpensive receiving circuit 114 occupying less space.

The transmitting circuit 114 includes an address set switch 124 to identify the transmitting circuit 114. The address set switch 124 couples the transmitting circuit 114 with each control circuit 122 to be described which may be utilized by the anti-theft vehicle system 10. The address set switch 124 includes, in one embodiment, eight individual switches 126 which are preset by the operator of the anti-theft vehicle system 10 to insure the proper operation thereof. The transmitting circuit 114 also includes an encoder 128 which receives the output of the address set switch 124. The encoder 128 is a digital encoder that establishes the address and engage (or disengage) command to be transmitted by the signal.

The transmitting circuit 114 further includes a modulator 130 and amplifier 131 which receives the output of the low pass filter 120 and the encoder 128. The modulator 130 allows the digital encoder 128 to modulate the signal received by the low pass filter 120. The amplifier 131 amplifies the signal received by the modulator 130. The transmitting circuit 114 also includes a low impedance transmitter 132. The transmitter 132 transmits the predetermined perimeter signal 116. In one embodiment, the amplifier 131 is the transmitter which is also the antenna. In one embodiment, the transmitter 132 is a closed circuit or antenna of conducting material which surrounds an area such as the parking lot and defines the predetermined spatial perimeter 11a for the shopping carts 22 to be contained within. It should be appreciated that the amplifier 131 must be able to provide enough current to drive the low impedance transmitter 132.

Referring to FIG. 9, another embodiment of the transmitting circuit 114 is shown. Like primed numerals represent similar elements to that of the transmitting circuit 114 shown in FIG. 7. The transmitting circuit 114' includes a remotely transportable or hand-held transmitter 132' for transmitting the predetermined perimeter signal having the same carrier frequency discussed above. The transmitting circuit 114' is used on individual shopping carts 22 to either lock or unlock the inhibitor 24 with the wheel 12 depending on the location

of the shopping cart **22**. By way of example, if the shopping cart **22** is located out beyond the predetermined spatial perimeter **11a**, the anti-theft vehicle system **10** will have locked the wheel **12** preventing the rotation thereof. The remotely transportable transmitter **132'** can be transported to the shopping cart **22** to unlock the wheel **12** so that the shopping cart **22** may be pushed back within the predetermined spatial perimeter **11a**.

Referring to FIG. 8, another embodiment **122**, according to the present invention, of the control circuit **69** is shown and receives the predetermined perimeter signal **116**. The control circuit **122** is a near field resonant receiver that detects and eventually decodes a pulse modulated magnetic field. Upon receiving the predetermined perimeter signal **116**, the receiving circuit **122** sends a signal to activate the motor **40** to move the inhibitor **24** to engage or disengage the wheel **12**. It should be appreciated that the control circuit **122** is disposed within the hub **18** of the wheel **12**.

The control circuit **122** includes a resonant tank circuit **138** which eliminates reception by the control circuit **122** of all frequencies other than the frequency of the predetermined perimeter signal **116**. The resonant tank circuit **138** is tuned to the specific harmonic, fundamental or otherwise, transmitted by the transmitting circuit **114**. The resonant tank circuit **138** allows for the detection of the predetermined perimeter signal **116** without having to provide any radio frequency (RF) gain. The resonant tank circuit **138** includes a capacitor and an inductor (neither shown) connected in parallel. It should be appreciated other elements may be used to favor the predetermined perimeter space frequencies to be received. It should also be appreciated that the shopping cart **22** is used as an antenna to receive the predetermined perimeter signal transmitted by the transmitting circuit **114,114'** and prevent electromagnetically isolating the wheel **12** to bypass the anti-theft vehicle system **10**.

The control circuit **122** also includes a gain stage circuit **140** electrically connected to the resonant tank circuit **138** and amplifies the predetermined perimeter signal **116** after the predetermined perimeter signal **116** has been received by the resonant tank circuit **138**. The gain stage circuit **140** may be a simplified circuit because it is only receiving one harmonic of an oscillating signal due to the tuning of the resonant tank circuit **138**. The gain stage circuit **140** amplifies the predetermined perimeter signal **116** by a predetermined amount such of nineteen decibels (19 db). The gain stage circuit **140** is configured as a linear mode amplifier that draws a predetermined current such as five microamps (5.0 μ A).

The control circuit **122** further includes a detector **142** which is electrically connected to the gain stage circuit **140**. The detector **142** receives the predetermined perimeter signal **116** without the unwanted harmonics which are not received due to the specific tuning of the resonant tank circuit **138**.

The control circuit **122** includes a post detection amplifier **143** for post detection gain. The post detection amplifier **143** is direct current (DC) coupled to the detector **142** to provide a ground source to an inverted input of a final gain stage to be described. This DC ground path causes the gain stage circuit **140** to invert the ground or zero potential signal to a maximum positive voltage signal. The positive voltage signal is then DC coupled to the post detection amplifier **143** which, in turn, inverts it again, back to a zero potential, prior to sending it to a decoder **148** to be described.

The control circuit **122** also includes an address set switch **144** similar to that of the transmitting circuit **114**. The

address set switch **144** includes a plurality of individual switches **146** which are set to a specific code or combination to match the individual switches **126** of the transmitting circuit **114**.

The control circuit **122** includes a decoder **148** which is maintained in a standby mode when the potential signal is zero. When the potential signal is high, the decoder **148** matches the predetermined perimeter signal **116** from the post detection amplifier with that of the predetermined perimeter signal **116** created by the address set switch **144** to determine whether the signal is from the transmitting circuit **114**. In one embodiment, the decoder **148** checks the predetermined perimeter signal **116** three times. If the decoder **148** determines that it has received a valid signal from the transmitting circuit **114**, the decoder **148** then determines whether the wheel **12** is to be locked or unlocked.

The control circuit **122** includes a latch **157** to reset the decoder **148** to prevent redundant lock and unlock actuations. The latch **157** receives a signal from the decoder **148**. The latch **157** is a flip flop which will allow a lock signal to pass to a lock drive timer **150** only if the immediately preceding signal was not a lock signal. This prevents redundant lock signals unnecessarily reducing the battery potential. Likewise, the latch **157** will prevent an unlock signal from passing to an unlock drive **156** if it was immediately preceded by an unlock signal. The latch **157** prevents signals resulting from the resonant tank circuit **138** being physically close to the antenna **76**. The latch **157** includes three CMOS transistors (none shown).

The anti-theft vehicle system **10** further includes a stall detecting circuit **158** which detects when the motor **40** stops the rotational movement. The stall detect circuit **158** will override the signal sent by the decoder **148** and prematurely terminate the rotation of the motor **40** by the lock drive **152** or the unlock drive **156**. The stall detecting circuit **158** determines when the inhibitor **24** is in its fully retracted position or its fully extended position against the wheel **12**.

Referring to FIG. 20, the transmitter is generally indicated at **200**. The transmitter **200** is shown having an amplifier **202**. The output of the amplifier **202** is sent along a plurality of antenna branches **204**. These antenna branches **204** may be configured in a manner suitable for the space about which the antenna branches **204** need to surround. The level of signal output is controlled by a potentiometer **206**.

The present invention has been described in an illustrative manner. It is to be understood that the terminology which has been used is intended to be in the nature of words of description rather than of limitation.

Many modifications and variations of the present invention are possible in light of the above teachings. Therefore, within the scope of the appended claims, the present invention may be practiced otherwise than as specifically described.

What is claimed is:

1. An anti-theft vehicle system for a vehicle comprising: at least one inhibitor operatively associated with the vehicle to resist and allow movement of the vehicle; a receiving circuit operatively associated with the vehicle to receive a predetermined square wave signal having a frequency of less than nine kilohertz to activate and move said at least one inhibitor; and

at least one transmitter for transmitting the predetermined signal to define a predetermined spatial perimeter.

2. An anti-theft vehicle system as set forth in claim 1 including a structure operatively associated with the vehicle and cooperating with said at least one inhibitor for moving

said at least one inhibitor between an engaged position and a disengaged position.

3. An anti-theft vehicle system as set forth in claim 2 wherein said structure is rotatable.

4. An anti-theft vehicle system as set forth in claim 1 including a remotely transportable transmitter for transmitting the predetermined signal.

5. An anti-theft vehicle system for a vehicle comprising: at least one vehicle wheel;

a structure operatively associated with said at least one vehicle wheel for moving between an engaged position and a disengaged position with respect to said at least one vehicle wheel to resist and allow rotational movement of said at least one vehicle wheel;

a receiving circuit operatively associated with said at least one vehicle wheel to receive a predetermined signal having a frequency of less than nine kilohertz to activate and move said structure between said engaged position and said disengaged position; and

a remotely transportable transmitter for transmitting the predetermined signal.

6. An anti-theft vehicle system as set forth in claim 5 wherein said remotely transportable transmitter is hand-held.

7. An anti-theft vehicle system as set forth in claim 5 including at least one signal generator to generate the predetermined signal to define a predetermined spatial perimeter.

8. An anti-theft system for a shopping cart comprising: at least one vehicle wheel;

at least one inhibitor operatively associated with said at least one vehicle wheel to engage and disengage said at least one vehicle wheel to resist and allow rotational movement of said at least one vehicle wheel;

a structure operatively associated with said at least one vehicle wheel and cooperating with said at least one inhibitor for moving said at least one inhibitor between an engaged position and a disengaged position with respect to said at least one vehicle wheel;

a receiving circuit operatively associated with said at least one vehicle wheel to receive a predetermined signal to activate said structure to move said at least one inhibitor between said engaged position and said disengaged position; and

a remotely transportable transmitter for transmitting the predetermined signal having a frequency of less than nine kilohertz.

9. An anti-theft vehicle system as set forth in claim 8 wherein said remotely transportable transmitter is hand-held.

10. An anti-theft system for a shopping cart comprising: at least one inhibitor operatively associated with the shopping cart to resist and allow movement of the shopping cart;

a receiving circuit operatively associated with the shopping cart to receive a predetermined square wave signal having a frequency of less than nine kilohertz to activate said at least one inhibitor; and

at least one transmitter to generate said predetermined signal to define a predetermined spatial perimeter.

11. An anti-theft system as set forth in claim 10 wherein said at least one transmitter comprises a signal generator and a buried wire cable.

12. An anti-theft system as set forth in claim 10 wherein said at least one transmitter includes an address set switch to identify said at least one transmitter.

13. An anti-theft system as set forth in claim 10 including a remotely transportable transmitter for transmitting said predetermined signal.

14. An anti-theft system as set forth in claim 13 wherein said remotely transportable transmitter is hand-held.

15. An anti-theft system for a shopping cart comprising: at least one inhibitor operatively associated with the shopping cart to resist and allow movement of the shopping cart;

a receiver operatively associated with the shopping cart to receive a predetermined signal having a frequency of less than nine kilohertz to activate said at least one inhibitor; and

a hand-held transmitter for transmitting said predetermined signal.

16. An anti-theft vehicle system for a vehicle comprising: at least one inhibitor operatively associated with the vehicle to resist and allow movement of the vehicle;

a receiving circuit operatively associated with the vehicle to receive a predetermined signal having a frequency of less than nine kilohertz to activate and move said at least one inhibitor; and

a remotely transportable transmitter for transmitting the predetermined signal.

17. An anti-theft vehicle system as set forth in claim 16 wherein said remotely transportable transmitter is hand-held.

18. An anti-theft vehicle system as set forth in claim 16 including a structure operatively associated with the vehicle and cooperating with said at least one inhibitor for moving said at least one inhibitor between an engaged position and a disengaged position.

* * * * *